

TOWN OF HOPKINTON

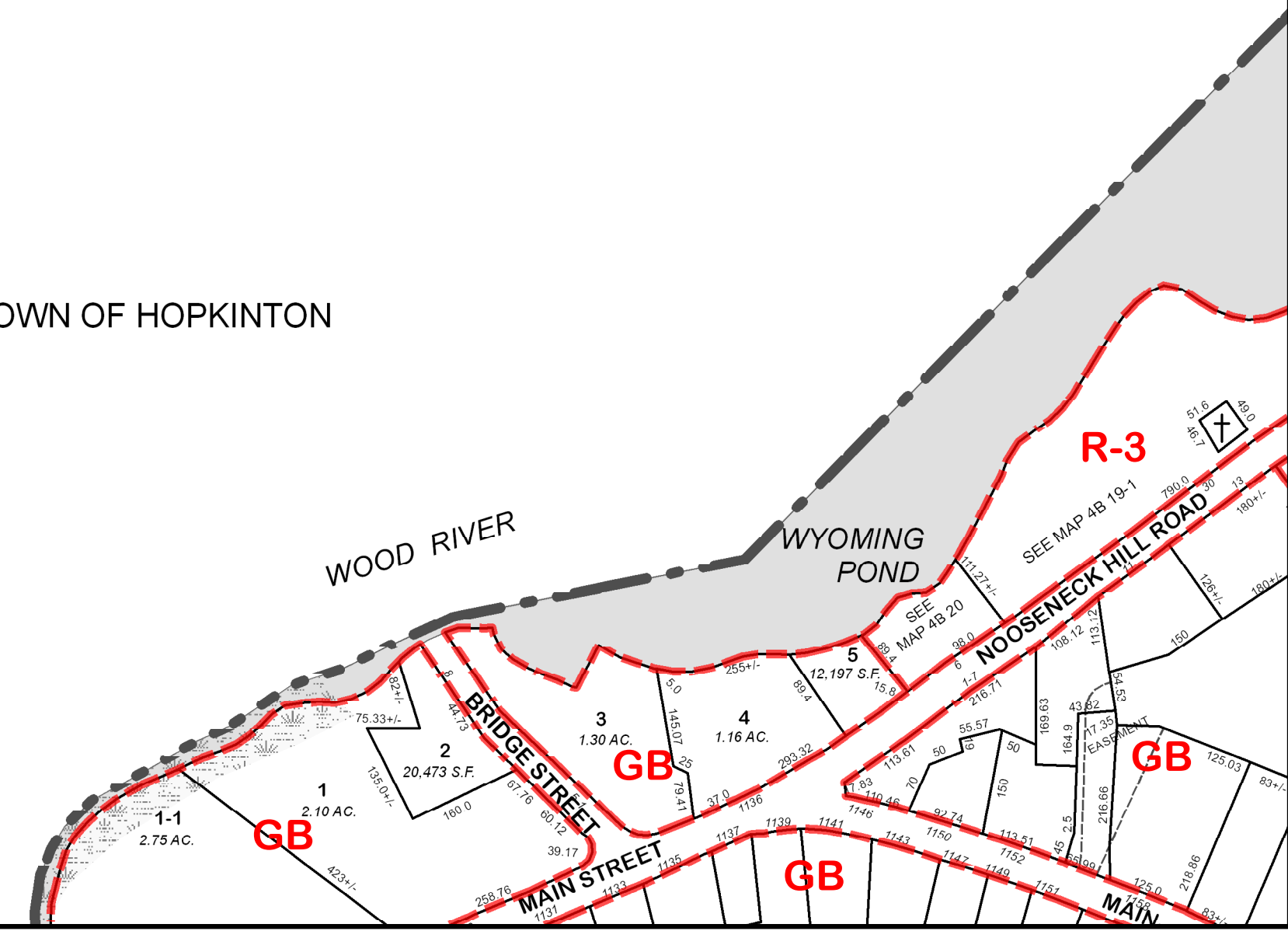

INDEX TO ADJOINING PLATS

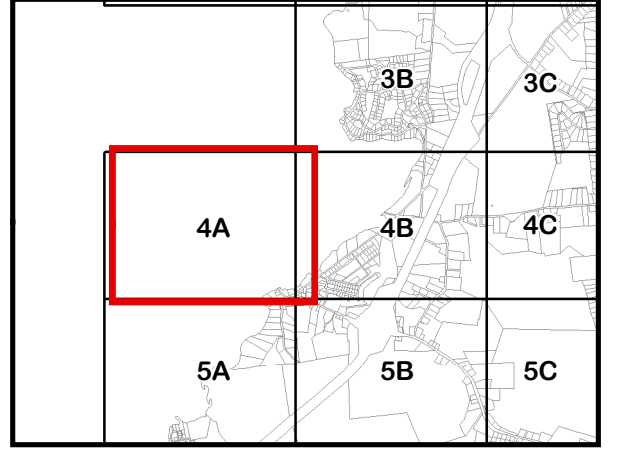

PLAT NUMBER  
**4A**

LEGEND

- 12 PARCEL NUMBER
- STREAM
- POND, OPEN WATER
- WET AREA (not legal)
- RAILROAD
- CEMETERY
- ACRES
- SQUARE FEET
- SCALED AREA
- DEEDED AREA
- TOWN BOUNDARY
- ZONING DISTRICT BOUNDARY
- RESIDENTIAL, 1 ACRE MINIMUM
- RESIDENTIAL, 2 ACRE MINIMUM
- RESIDENTIAL, 3 ACRE MINIMUM
- GENERAL BUSINESS
- NEIGHBORHOOD BUSINESS
- PLANNED DEVELOPMENT
- INDUSTRIAL
- LIGHT INDUSTRIAL
- PLANNED UNIT DEV'MENT-- VILLAGE CNTR
- FLEX TECH

- R-1
- R-2
- R-3
- GB
- NB
- PD
- I
- LI
- PUDVC
- FT

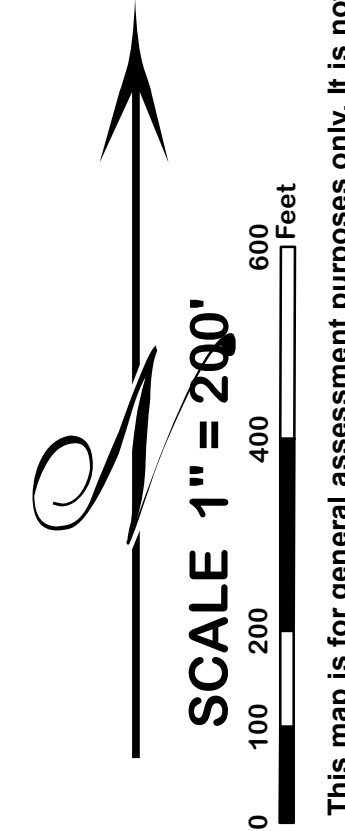

Disclaimer: This map is for general assessment purposes only. It is not a legal description, conveyance or product of a Professional Land Survey. Lot areas sourced from Assessor's property database. Wet areas are not legal definitions and approximate only. Zoning information is for general planning purposes only and is not an official record.  
Data Sources: (C) 2010 Town of Richmond GIS and RIGIS Wetlands 1998.  
Prepared by: Mapping and Planning Services, Jamestown, RI (MH 10/2011)

TOWN OF  
**RICHMOND**  
WASHINGTON COUNTY -- RHODE ISLAND  
**TAX ASSESSOR'S MAPS**  
**WITH ZONING**

Includes TAX MAP REVISIONS through DECEMBER 31, 2010  
Includes ZONING AMENDMENTS through SEPTEMBER 7, 2010  
Note: The Zoning Overlay Districts (Agricultural, Aquifer and Flood) are not depicted on these maps.  
See "Official Zoning Map" located in Town Clerk's Office.