

TOWN OF  
**RICHMOND**  
 WASHINGTON COUNTY -- RHODE ISLAND  
**TAX ASSESSOR'S MAPS**  
**WITH ZONING**  
*Includes TAX MAP REVISIONS through DECEMBER 31, 2010*  
*Includes ZONING AMENDMENTS through SEPTEMBER 7, 2010*  
*Note: The Zoning Overlay Districts (Agricultural, Aquifer and Flood) are not depicted on these maps.*  
*See "Official Zoning Map" located in Town Clerk's Office.*

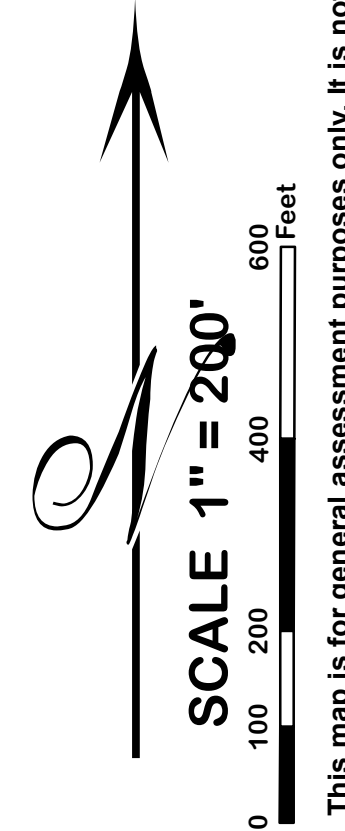

Disclaimer: This map is for general assessment purposes only. It is not a legal description, conveyance or product of a Professional Land Survey. Lot areas sourced from Assessor's property database. Wet areas are not legal definitions and approximate only. Zoning information is for general planning purposes only and is not an official record.  
 Data Sources: (C) 2010 Town of Richmond GIS and RIGIS Wetlands 1998.  
 Prepared by: Mapping and Planning Services, Jamestown, RI (MH 10/2011)

- R-1
- R-2
- R-3
- GB
- NB
- PD
- I
- LI
- PUDVC
- FT

**LEGEND**

12	ZONING DISTRICT BOUNDARY
STREAM	RESIDENTIAL, 1 ACRE MINIMUM
POND, OPEN WATER	RESIDENTIAL, 2 ACRE MINIMUM
WET AREA (not legal)	RESIDENTIAL, 3 ACRE MINIMUM
RAILROAD	GENERAL BUSINESS
CEMETERY	NEIGHBORHOOD BUSINESS
ACRES	PLANNED DEVELOPMENT
57.5 AC.	INDUSTRIAL
20,000 S.F.	LIGHT INDUSTRIAL
SQUARE FEET	PLANNED UNIT DEV'TMENT-- VILLAGE CNTR
AREA IN -	FLEX TECH
SCALED AREA	
DEEDED AREA	
TOWN BOUNDARY	

**INDEX TO ADJOINING PLATS**

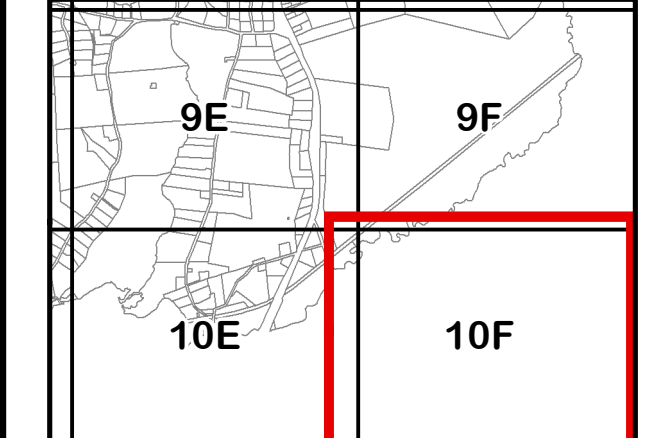

**PLAT NUMBER**  
**10F**